

# SAW LINES - KOHLER JENKINS

---

PART #100-755A THROAT PLATE



PART #100-755B RIP SAW, NORTH

PART #100-755C CROSS CUT #3



PART #100-755D RIP SAW, MIDDLE

PART #100-755E CROSS CUT #2

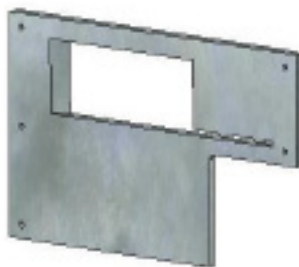

PART #100-755F CROSS CUT, WEST

PART #100-755G CROSS CUT, EAST

